





3	<b>University Examination Infrastructure:</b> Strong Room for examination a) (Area- 300 sq.ft, b) Shelf, c) Steel cupboard – I, d) CCTV, Photocopier Machine, Examination hall with benches, Parking Facility for University vehicle, Guest house facility	---	
4	<b>Other facilities:</b> Hospital Waste Management, Medical Education Unit, Intercom Network, Playground, P.T Teacher or Instructor, Cafeteria, Facility for indoor games, Gymnasium / Gymkhana Facility, Is there any LMS (learning management system software) available	Yes	
5	<b>Hostel facility:</b> Boys (UG & PG), Girls (UG & PG), Interns, Residents, Warden/ Rector, Hygiene, Vending Machine etc.	Yes	

#### Hospital

6	HospitalDetails: Affiliated	Details onCollege Website	Adequate/Ina dequate
	<b>Nameof theHospital: General Hospital Oros</b>	Yes	Adequate
	<b>Address:Ap. Oros, Tal, Kudal Dist. Sindhudurg. Pin 416812</b>		
	<b>TelephoneNo.:02362-228901</b>		
	<b>BedStrength:330</b>		
	<b>DistanceofHospitalfrom theCollegetowhichitisattached (inkms)20. KM</b>	-	
	<b>Numberof bedsregistered asperBNHAct330</b>	Yes	Adequate
	<b>Nameof theHospital: Sub District Hospital, Kankavali</b>		
	<b>Address: Ap. Kankavali, Tal, Kankavali Dist. Sindhudurg. Pin 416602</b>		
	<b>TelephoneNo.: 02367-232058</b>		
	<b>BedStrength:100</b>		
	<b>DistanceofHospitalfrom theCollegetowhichitisattached (inkms) 15. KM</b>	-	
	<b>Numberof bedsregistered asperBNHAct 330</b>	Yes	Adequate
	<b>Nameof theHospital: Lifetime Hospital, Padave, Sindhudurg</b>		
	<b>Address: Ap. Padave, Kasal. Tal, Kudal Dist. Sindhudurg. Pin</b>		
	<b>TelephoneNo.: 02367-234000.</b>		
	<b>BedStrength:300</b>		
	<b>DistanceofHospitalfrom theCollegetowhichitisattached (inkms) 20. KM</b>	-	
	<b>Numberof bedsregistered asperBNHAct 330</b>	Yes	Adequate
7	<b>I.TotalconstructedareaofHospitalBuildingasperMSR(.....Sq.mtr./Sq.ft.)</b>	Yes	
	<b>WhethertheHospitalisOwned bytheCollege/ ManagementorRented?</b>	Yes	
	<b>II.HospitalAdministration Block asperMSR</b> (Superintendentroom,DeputySuperintendentroom,Medicalofficers`room,Matron room,AssistantMatronroom,Receptionand Registration,etc.)	Yes	
	<b>III.Out-PatientDepartments(OPD)asperMSR</b> TotalAreaofOPDComplex...Sq.ft. No.ofOPD's .....FacilitiesshallbeasperMSR&alldetailshallbeoncollegewebsite.	Yes	
	<b>IV.InPatientDepartments(IPD)asperMSR</b> TotalAreaofIPDComplex...Sq.ft. No.ofIPDDepartments..... Bed Distribution..... FacilitiesshallbeasperMSR &alldetailshallbeoncollegewebsite.	Yes	
	<b>V.OperationTheatresBlock as perMSR</b> TotalAreaofOT Block ...sq.ft. No.of OTs available .....FacilitiesshallbeasperMSR &alldetailshallbeoncollegewebsite.	Yes	
	<b>VI.CasualtyFacilities</b> StateGovernmentPermissionLetter	Yes	
	<b>VII. Central Clinical Laboratory:</b> Well-equipped with separate sections forPathology, Biochemistry and Micro-biology. Attached toilet shall be there forcollectionofurinesamples.Other diagnostictoolsforECGorTMT etc.shallbeprovided.	Yes	
	<b>VIII.RadiologyorSonographySection:</b> Radiologistchamber,X-rayroom, Darkroom,filmdryingroom,storeroom,patientswaitinganddressingroom,receptionor registrationorreportroom.	Yes	
	<b>IX.LabourRoom:</b>	Yes	



  
**PRINCIPAL,**  
 Dean/Principal Stamp & Signature  
 41 & Post - Tondavali, Dist. Sindhudurg  
 Page 2 of 2

# Physical Facilities

## Teaching block

Sr. No	Teaching Block <sup>^</sup>	Area (in Sq. ft)	Seating Capacity	Ventilation	Light	Remarks
1	Lecture Hall (04)	1080X4= 4320	1080X10 =10800	Yes	Yes	
Laboratories	1) Fundamental of Nsg.	1500	1500	Yes	Yes	
	2) Nutrition --	900	900			
	3) M.C.H. -	900	900			
	4) C.H.N.	900	900			
	5) Computer	1500	1000			
	6) A.V. Aids.	600	0			
	7) Preclinical science Lab	900	900			
Staff Section	1) Principal Room	300	400	Yes	Yes	
	2) Vice- Principal Room	200	300			
	3) Faculty Room	2400	2800			
	4) Staff Room	1000	1200			
	5) Common Room(M/F)	1100	1000			
	6) Multipurpose Hall/ Auditorium	3000	3000			
	7) One Room for each HOD	800	NA			
Library	1) Reading Room 2) Librarian Room 3) Computer with Internet Facilities	2400	3600	Yes	Yes	
Lavatory Area	1) Toilet (Separate for Girls & Boys)	1000	1900	Yes	Yes	
	<b>Total Area</b>	<b>23,720</b>	<b>31,077.82</b>	--	--	

*[Signature]*

**PRINCIPAL,**  
Shree Saraswati College of Nursing  
Ai & Post - Tondavali, Dist. Sindhudurg



# Physical Facilities

## Hostel block

Sr. No.	Hostel Block	Area (in Sq. ft)	Remark Yes/No
1	Single Room	22422	yes
	Double Room		
2	Sanitary facilities (one Latrine, One Bathroom for 5 to 6 Students)	500	Yes
3	Visitors Room	500	Yes
4	Reading Room	250	Yes
5	Store Room	500	Yes
6	Recreation Room	500	Yes
	Total Area	24672	

# Physical Facilities

## Kitchen & Drinking Water

1	Dining Hall & Drinking Water Facility	3000	Yes
2	Kitchen & Store Room	1500	Yes
	Total Area	30750	



**PRINCIPAL,**

Shree Saraswati College of Nursing  
At & Post - Tondavali, Dist. Sindhudurg



Date: - 21/09/2020

**To Whomsoever Concern**

I hereby certify that the erection of Hostel Building on Revenue on Revenue Survey No.276/1 & 279, At/Post Tondavali, Nandgaon – Phonda Road, Taluka Kankavali, Dist Sindhudurg, situated at Tondavali-Iswalkarwadi Road has been supervised by me and has been completed on 25/12/2018 according to plans sanctioned, vide office communication No. JAK/34/SR/249/2015 dated 01/04/2015. Following are the areas of the building completed on site.

Hostel Building				
Sr.No	Particular	Sq Mtr.	Sq Ft.	Type of Construction
1	Old Building	633.92	6823.46	RCC
2	New Building	2,253.28	24,254.36	RCC
Total Area		2,887.20	31,077.82	



Signature of the Architect

Name of the architect: - Milind P. Surve

Registration no- CA/99/25256



**PRINCIPAL,**

**Shree Saraswati College of Nursing,  
At & Post - Tondavali, Dist. Sindhudurg**

Date: - 18/09/2020

**To Whomsoever Concern**

I hereby certify that the erection of Educational Building on Revenue Survey No.274 At/Post Tondavali, Nandgaon – Phonda Road, Taluka Kankavali, Dist Sindhudurg, situated at Tondavali-Iswalkarwadi Road has been supervised by me and has been completed on 25/12/2018 according to plans sanctioned, vide office communication No. JAK/SR/254/2016 dated 09/03/2016. Following are the areas of the building completed on site.

Hostel Building				
Sr.No	Particular	Sq Mtr.	Sq Ft.	Type of Construction
1	Old Building	1035.57	11146.78	RCC
2	New Building	1,256.47	13,524.67	RCC
Total Area		2,292.04	24,671.45	

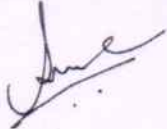

Signature of the Architect

Name of the architect: - Milind P. Surve

Registration no- CA/99/25286



**PRINCIPAL,**

~~Shree~~ Saraswati College of Nursing  
At & Post - Tondavali, Dist. Sindhudurg



PROFORMA - A  
 CONTENTS OF SHEET  
 SITE AREA, AREA DIAGRAM  
 AREA CALCULATION  
 BUILDING PLAN, SECTION PLAN, etc.  
 STAMP OF DT OF SUB. OF PLAN

STAMP OF DT OF APPROVAL OF PLAN

CERTIFICATE OF AREA  
 CERTIFIED THAT THE PLOT UNDER REFERENCE WAS SURVEYED BY ME OR BY A TYPED INSTRUMENT OF SURVEY & THE TRUE AREA IS AS SHOWN ON THE PLAN & WORKED OUT TABLES WITH AN AREA 150.00 M<sup>2</sup> RECORDS PLANS AND CONDS OF SURVEYING BY ME

DESCRIPTION OF PROPOSAL  
 PROPOSED COLLEGE BUILDING  
 UNIT NO. - 274  
 VILLAGE - TONDIVALI  
 TALUKA - KARNATAVA  
 DIST. - SHIRAHOLUR  
 DATE - / /  
 NAME, ADD & SIGN OF OWNER

SHIRAHOLUR EDUCATION SOCIETY  
 ALTERNATE ARCHT.  
 ARCHITECTURAL DRAWING  
 The above plan, section & other details are submitted for the purpose of obtaining sanction for the proposed building.

PROFORMA - B  
 AREA STATEMENT

Sl. No.	Particulars	Area (Sq. Mts)
1	Area of the total plot or site	150.00
2	Area of the road	10.00
3	Area of the building	140.00
4	Area of the open space	10.00
5	Area of the reserved area	10.00
6	Area of the reserved area	10.00
7	Area of the reserved area	10.00
8	Area of the reserved area	10.00
9	Area of the reserved area	10.00
10	Area of the reserved area	10.00
11	Area of the reserved area	10.00
12	Area of the reserved area	10.00
13	Area of the reserved area	10.00
14	Area of the reserved area	10.00
15	Area of the reserved area	10.00
16	Area of the reserved area	10.00
17	Area of the reserved area	10.00
18	Area of the reserved area	10.00
19	Area of the reserved area	10.00
20	Area of the reserved area	10.00
21	Area of the reserved area	10.00
22	Area of the reserved area	10.00
23	Area of the reserved area	10.00
24	Area of the reserved area	10.00
25	Area of the reserved area	10.00
26	Area of the reserved area	10.00
27	Area of the reserved area	10.00
28	Area of the reserved area	10.00
29	Area of the reserved area	10.00
30	Area of the reserved area	10.00
31	Area of the reserved area	10.00
32	Area of the reserved area	10.00
33	Area of the reserved area	10.00
34	Area of the reserved area	10.00
35	Area of the reserved area	10.00
36	Area of the reserved area	10.00
37	Area of the reserved area	10.00
38	Area of the reserved area	10.00
39	Area of the reserved area	10.00
40	Area of the reserved area	10.00
41	Area of the reserved area	10.00
42	Area of the reserved area	10.00
43	Area of the reserved area	10.00
44	Area of the reserved area	10.00
45	Area of the reserved area	10.00
46	Area of the reserved area	10.00
47	Area of the reserved area	10.00
48	Area of the reserved area	10.00
49	Area of the reserved area	10.00
50	Area of the reserved area	10.00
51	Area of the reserved area	10.00
52	Area of the reserved area	10.00
53	Area of the reserved area	10.00
54	Area of the reserved area	10.00
55	Area of the reserved area	10.00
56	Area of the reserved area	10.00
57	Area of the reserved area	10.00
58	Area of the reserved area	10.00
59	Area of the reserved area	10.00
60	Area of the reserved area	10.00
61	Area of the reserved area	10.00
62	Area of the reserved area	10.00
63	Area of the reserved area	10.00
64	Area of the reserved area	10.00
65	Area of the reserved area	10.00
66	Area of the reserved area	10.00
67	Area of the reserved area	10.00
68	Area of the reserved area	10.00
69	Area of the reserved area	10.00
70	Area of the reserved area	10.00
71	Area of the reserved area	10.00
72	Area of the reserved area	10.00
73	Area of the reserved area	10.00
74	Area of the reserved area	10.00
75	Area of the reserved area	10.00
76	Area of the reserved area	10.00
77	Area of the reserved area	10.00
78	Area of the reserved area	10.00
79	Area of the reserved area	10.00
80	Area of the reserved area	10.00
81	Area of the reserved area	10.00
82	Area of the reserved area	10.00
83	Area of the reserved area	10.00
84	Area of the reserved area	10.00
85	Area of the reserved area	10.00
86	Area of the reserved area	10.00
87	Area of the reserved area	10.00
88	Area of the reserved area	10.00
89	Area of the reserved area	10.00
90	Area of the reserved area	10.00
91	Area of the reserved area	10.00
92	Area of the reserved area	10.00
93	Area of the reserved area	10.00
94	Area of the reserved area	10.00
95	Area of the reserved area	10.00
96	Area of the reserved area	10.00
97	Area of the reserved area	10.00
98	Area of the reserved area	10.00
99	Area of the reserved area	10.00
100	Area of the reserved area	10.00

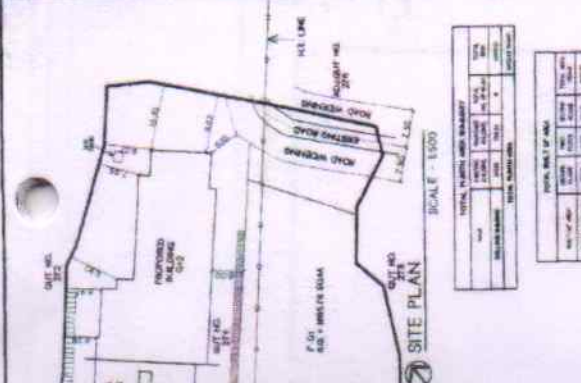

R.G. CALCULATIONS

Sl. No.	Particulars	Area (Sq. Mts)
1	Area of the total plot or site	150.00
2	Area of the road	10.00
3	Area of the building	140.00
4	Area of the open space	10.00
5	Area of the reserved area	10.00
6	Area of the reserved area	10.00
7	Area of the reserved area	10.00
8	Area of the reserved area	10.00
9	Area of the reserved area	10.00
10	Area of the reserved area	10.00
11	Area of the reserved area	10.00
12	Area of the reserved area	10.00
13	Area of the reserved area	10.00
14	Area of the reserved area	10.00
15	Area of the reserved area	10.00
16	Area of the reserved area	10.00
17	Area of the reserved area	10.00
18	Area of the reserved area	10.00
19	Area of the reserved area	10.00
20	Area of the reserved area	10.00
21	Area of the reserved area	10.00
22	Area of the reserved area	10.00
23	Area of the reserved area	10.00
24	Area of the reserved area	10.00
25	Area of the reserved area	10.00
26	Area of the reserved area	10.00
27	Area of the reserved area	10.00
28	Area of the reserved area	10.00
29	Area of the reserved area	10.00
30	Area of the reserved area	10.00
31	Area of the reserved area	10.00
32	Area of the reserved area	10.00
33	Area of the reserved area	10.00
34	Area of the reserved area	10.00
35	Area of the reserved area	10.00
36	Area of the reserved area	10.00
37	Area of the reserved area	10.00
38	Area of the reserved area	10.00
39	Area of the reserved area	10.00
40	Area of the reserved area	10.00
41	Area of the reserved area	10.00
42	Area of the reserved area	10.00
43	Area of the reserved area	10.00
44	Area of the reserved area	10.00
45	Area of the reserved area	10.00
46	Area of the reserved area	10.00
47	Area of the reserved area	10.00
48	Area of the reserved area	10.00
49	Area of the reserved area	10.00
50	Area of the reserved area	10.00
51	Area of the reserved area	10.00
52	Area of the reserved area	10.00
53	Area of the reserved area	10.00
54	Area of the reserved area	10.00
55	Area of the reserved area	10.00
56	Area of the reserved area	10.00
57	Area of the reserved area	10.00
58	Area of the reserved area	10.00
59	Area of the reserved area	10.00
60	Area of the reserved area	10.00
61	Area of the reserved area	10.00
62	Area of the reserved area	10.00
63	Area of the reserved area	10.00
64	Area of the reserved area	10.00
65	Area of the reserved area	10.00
66	Area of the reserved area	10.00
67	Area of the reserved area	10.00
68	Area of the reserved area	10.00
69	Area of the reserved area	10.00
70	Area of the reserved area	10.00
71	Area of the reserved area	10.00
72	Area of the reserved area	10.00
73	Area of the reserved area	10.00
74	Area of the reserved area	10.00
75	Area of the reserved area	10.00
76	Area of the reserved area	10.00
77	Area of the reserved area	10.00
78	Area of the reserved area	10.00
79	Area of the reserved area	10.00
80	Area of the reserved area	10.00
81	Area of the reserved area	10.00
82	Area of the reserved area	10.00
83	Area of the reserved area	10.00
84	Area of the reserved area	10.00
85	Area of the reserved area	10.00
86	Area of the reserved area	10.00
87	Area of the reserved area	10.00
88	Area of the reserved area	10.00
89	Area of the reserved area	10.00
90	Area of the reserved area	10.00
91	Area of the reserved area	10.00
92	Area of the reserved area	10.00
93	Area of the reserved area	10.00
94	Area of the reserved area	10.00
95	Area of the reserved area	10.00
96	Area of the reserved area	10.00
97	Area of the reserved area	10.00
98	Area of the reserved area	10.00
99	Area of the reserved area	10.00
100	Area of the reserved area	10.00

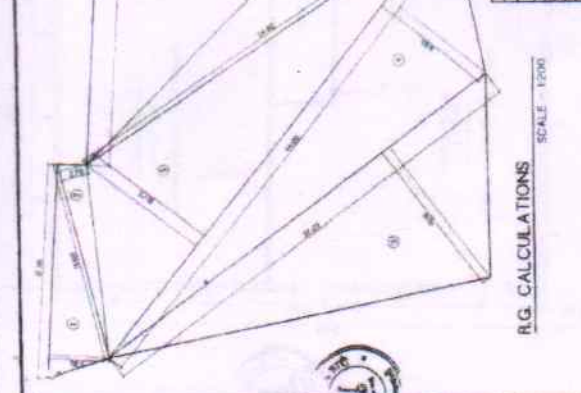

PROPOSED BUILDING  
 EXISTING BUILDING

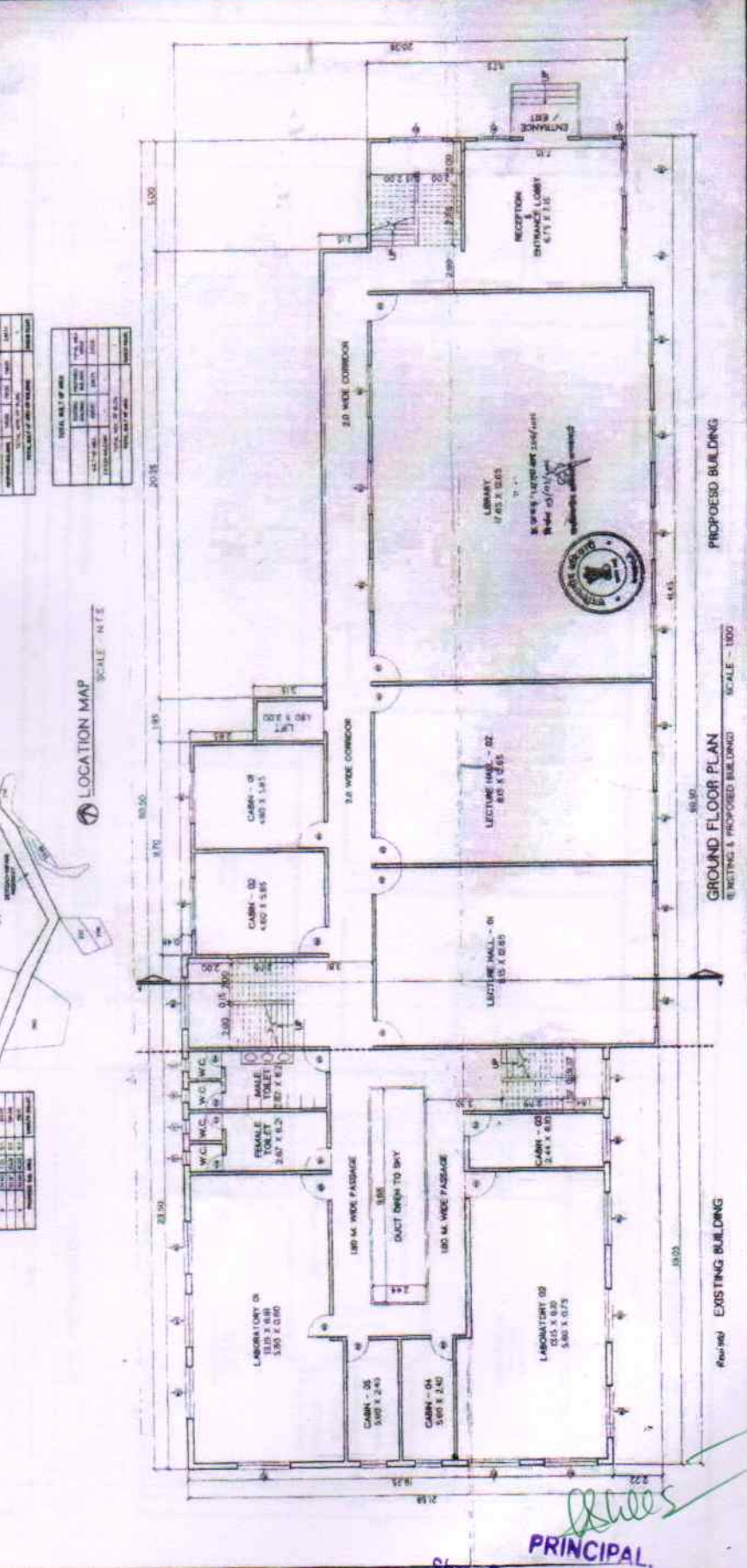

PROPOSED BUILDING  
 EXISTING BUILDING

PRINCIPAL  
 Shree Saraswati College of Nursing  
 41 & Post - Tondavali Dist. G.